

Modular line

AIRCOMP

042 1/4"

Codici di ordinazione
Order Code

Guida alle referenze
Guide to references

FR 1/4" 042 20 08 R TT SS

Prodotto
Product

R = Regolatore
Regulator

F = Filtro
Filter

MF = Microfiltro
Microfilter

L = Lubrificatore
Lubricator

FR = Filtro regolatore
Filter regulator

V3 = Valvola a 3 vie
Way on-off valve

SV = Valvola di sezionamento
Shut-off valve

AVP = Avviatore progressivo
Slow start valve

Connessione
Connection

1/4" = G1/4"

Linea
Line

042

Elemento filtrante
Filtering element

5 = 5 micron

20 = 20 micron

0,01 = 0,01 micron

Tipo speciale
Special Type

VL = Caricamento in depressione
Vacuum loading

B = Batteria (solo per "R")
Battery (only for "R")

Scarico
Drain

SS = Manuale e semi-automatico (standard)
Manual and semi-automatic (standard)

SA = Automatico a galleggiante
Automatic float type

SAD = Automatico differenziale
Automatic differential

Tazza
Bowl

PE = Protezione esterna
External protection

TT = Trasparente
Transparent

TC = Trasparente corta
Short transparent

Versione
Version

R = Relieving (per aria)
Relieving (for air)

A = Senza relieving (per acqua)
No relieving (for water)

Campo di regolazione
Range of pressure

04 = 0-4 Bar

08 = 0-8 Bar

12 = 0-12 Bar

Regolatore
Regulator



CODICE-CODE	REF.
042.01.00004	R 1/4" 042 04 R
042.01.00007	R 1/4" 042 08 R
042.01.00006	R 1/4" 042 12 R

Lubrificatore
Lubricator

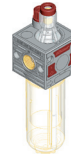

CODICE-CODE	REF.
042.03.00000	L 1/4" 042 TT
042.03.00072	L 1/4" 042 PE
042.03.00078	L 1/4" 042 TC (tazza corta - short bowl)
042.03.00500	L 1/4" 042 TT VL
042.03.00501	L 1/4" 042 PE VL

Regolatore per batteria
Regulator for battery

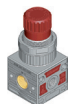

CODICE-CODE	REF.
042.01.00045	R 1/4" 042 02 R B
042.01.00046	R 1/4" 042 04 R B
042.01.00047	R 1/4" 042 08 R B
042.01.00048	R 1/4" 042 12 R B

Filtro regolatore
Filter regulator

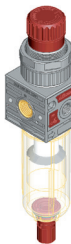

CODICE-CODE	REF.
042.04.00000	FR 1/4" 042 20 08 R TT SS
042.04.00052	FR 1/4" 042 20 12 R TT SS
042.04.00113	FR 1/4" 042 5 08 R TT SS
042.04.00114	FR 1/4" 042 5 12 R TT SS
042.04.00133	FR 1/4" 042 20 08 R TC SS (tazza corta-short bowl)
042.04.00229	FR 1/4" 042 20 12 R TC SS (tazza corta-short bowl)
042.04.00230	FR 1/4" 042 5 08 R TC SS (tazza corta-short bowl)
042.04.00251	FR 1/4" 042 5 12 R TC SS (tazza corta-short bowl)
042.04.00072	FR 1/4" 042 20 08 R PE SS
042.04.00127	FR 1/4" 042 20 12 R PE SS
042.04.00129	FR 1/4" 042 5 08 R PE SS
042.04.00130	FR 1/4" 042 5 12 R PE SS

Filtro
Filter

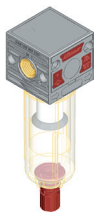

CODICE-CODE	REF.
042.02.00000	F 1/4" 042 20 TT SS
042.02.00109	F 1/4" 042 5 TT SS
042.02.00072	F 1/4" 042 20 PE SS
042.02.00118	F 1/4" 042 5 PE SS
042.02.00110	F 1/4" 042 20 TC SS (tazza corta - short bowl)
042.02.00176	F 1/4" 042 5 TC SS (tazza corta - short bowl)

Versione Scarico Automatico a galleggiante

Float type automatic drain version

042.02.00151	F 1/4" 042 20 TT SA
042.02.00152	F 1/4" 042 5 TT SA
042.02.00153	F 1/4" 042 20 PE SA
042.02.00154	F 1/4" 042 5 PE SA

Versione Scarico Automatico "Differenziale"

"Differential" automatic drain version

042.02.00180	F 1/4" 042 20 TT SAD
042.02.00181	F 1/4" 042 5 TT SAD
042.02.00182	F 1/4" 042 20 PE SAD
042.02.00183	F 1/4" 042 5 PE SAD

Versione Scarico Automatico a galleggiante

Float type automatic drain version

042.04.00151	FR 1/4" 042 20 08 R TT SA
042.04.00153	FR 1/4" 042 20 12 R TT SA
042.04.00154	FR 1/4" 042 5 08 R TT SA
042.04.00156	FR 1/4" 042 5 12 R TT SA
042.04.00157	FR 1/4" 042 20 08 R PE SA
042.04.00159	FR 1/4" 042 20 12 R PE SA
042.04.00160	FR 1/4" 042 5 08 R PE SA
042.04.00162	FR 1/4" 042 5 12 R PE SA

Versione Scarico Automatico "Differenziale"

"Differential" automatic drain version

042.04.00238	FR 1/4" 042 20 08 R TT SAD
042.04.00239	FR 1/4" 042 20 12 R TT SAD
042.04.00240	FR 1/4" 042 5 08 R TT SAD
042.04.00241	FR 1/4" 042 5 12 R TT SAD
042.04.00242	FR 1/4" 042 20 08 R PE SAD
042.04.00243	FR 1/4" 042 20 12 R PE SAD
042.04.00244	FR 1/4" 042 5 08 R PE SAD
042.04.00245	FR 1/4" 042 5 12 R PE SAD

Microfiltro antiolio a coalescenza
Coalescent oil-proof microfilter

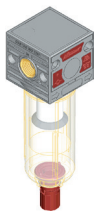

CODICE-CODE	REF.
042.02.00064	MF 1/4" 042 0,01 TT SS
042.02.00115	MF 1/4" 042 0,01 PE SS
042.02.00111	MF 1/4" 042 0,01 TC SS (tazza corta - short bowl)

Versione Scarico Automatico a galleggiante
Float type automatic drain version

042.02.00159	MF 1/4" 042 0,01 TT SA
042.02.00160	MF 1/4" 042 0,01 PE SA

Versione Scarico Automatico "Differenziale"
"Differential" automatic drain version

042.02.00184	MF 1/4" 042 0,01 TT SAD
042.02.00185	MF 1/4" 042 0,01 PE SAD

Per altre esecuzioni contattare l'ufficio commerciale
For further versions, please contact our sales dept.

→ = Standard version

Modular line

AIRCOMP

042 1/4"

Codici di ordinazione
Order Code

Per altre esecuzioni
contattare l'ufficio
commerciale

For further versions,
please contact our
sales dept.

→ = Standard version

Valvola d'intercettazione a 3 vie con blocco
3 Way on-off valve

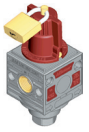

CODICE-CODE	REF.
→ 042.25.00001	V 1/4" 042 V 3

Valvola di sezionamento
Shut-off valve

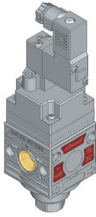

CODICE-CODE	REF.
→ 042.26.00002	SV 1/4" 042 Pred. C. Electr. Microsol/Pneum.
C50.26.00002	Kit. C. Electr. 3/2 NC 2W 24V DC Microsol
C50.26.00003	Kit. C. Electr. 3/2 NC 1W 24V AC Microsol
C50.26.00004	Kit. C. Electr. 3/2 NC 1W 110V AC Microsol
C50.26.00005	Kit. C. Electr. 3/2 NC 1W 220V AC Microsol
C40.26.00014	Kit. C. Pneum.

CODICE-CODE	REF.
→ 042.26.00001	SV 1/4" 042 Pred. C. Electr. Cnomo
C40.26.00011	C. Electr. EV 3/2 NC Cnomo
A50.26.00006	Sol. 2,5W 24 DC
A50.26.00007	Sol. 2,5W 24V AC
A50.26.00008	Sol. 2,5W 110V AC
A50.26.00009	Sol. 2,5W 220V AC
A50.26.00010	Conn. Cnomo

Avviatore progressivo
Slow start valve

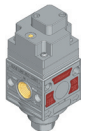

CODICE-CODE	REF.
→ 042.27.00001	AVP 1/4" 042 PN Autom.

Gruppo F+R+L
F+R+L Unit

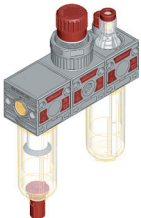

CODICE-CODE	REF.
→ 042.05.*****	F+R+L 1/4" 042 20 08 R TT SS
042.05.00103	F+R+L 1/4" 042 20 12 R TT SS
042.05.00105	F+R+L 1/4" 042 5 08 R TT SS
042.05.00106	F+R+L 1/4" 042 5 12 R TT SS
042.05.00170	F+R+L 1/4" 042 20 08 R TC SS
042.05.00171	F+R+L 1/4" 042 20 12 R TC SS
042.05.00172	F+R+L 1/4" 042 5 08 R TC SS
042.05.00173	F+R+L 1/4" 042 5 12 R TC SS
042.05.00500	F+R+L 1/4" 042 20 08 R TT SS VL
042.05.00504	F+R+L 1/4" 042 20 12 R TT SS VL
→ 042.05.00118	F+R+L 1/4" 042 20 08 R PE SS
042.05.00114	F+R+L 1/4" 042 20 12 R PE SS
042.05.00116	F+R+L 1/4" 042 5 08 R PE SS
042.05.00117	F+R+L 1/4" 042 5 12 R PE SS
042.05.00501	F+R+L 1/4" 042 20 08 R PE SS VL
042.05.00505	F+R+L 1/4" 042 20 12 R PE SS VL

Versione Scarico Automatico a galleggiante
Float type automatic drain version

042.05.00151	F+R+L 1/4" 042 20 08 R TT SA
042.05.00153	F+R+L 1/4" 042 20 12 R TT SA
042.05.00158	F+R+L 1/4" 042 20 04 R PE SA
042.05.00157	F+R+L 1/4" 042 20 08 R PE SA
042.05.00159	F+R+L 1/4" 042 20 12 R PE SA

Versione Scarico Automatico "Differenziale"
"Differential" automatic drain version

042.05.00166	F+R+L 1/4" 042 20 08 R TT SAD
042.05.00167	F+R+L 1/4" 042 20 12 R TT SAD
042.05.00168	F+R+L 1/4" 042 20 08 R PE SAD
042.05.00169	F+R+L 1/4" 042 20 12 R PE SAD

Gruppo FR+L
FR+L Unit

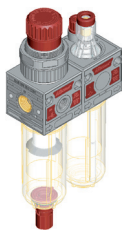

CODICE-CODE	REF.
→ 042.06.*****	FR+L 1/4" 042 20 08 R TT SS
042.06.00052	FR+L 1/4" 042 20 12 R TT SS
042.06.00115	FR+L 1/4" 042 5 08 R TT SS
042.06.00116	FR+L 1/4" 042 5 12 R TT SS
042.06.00124	FR+L 1/4" 042 20 08 R TC SS
042.06.00132	FR+L 1/4" 042 20 12 R TC SS
042.06.00133	FR+L 1/4" 042 5 08 R TC SS
042.06.00134	FR+L 1/4" 042 5 12 R TC SS
042.06.00500	FR+L 1/4" 042 20 08 R TT SS VL
042.06.00504	FR+L 1/4" 042 20 12 R TT SS VL
→ 042.06.00072	FR+L 1/4" 042 20 08 R PE SS
042.06.00126	FR+L 1/4" 042 20 12 R PE SS

Gruppo V3+FR+L
V3+FR+L Unit

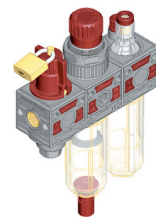

CODICE-CODE	REF.
→ 042.36.*****	V3+FR+L 1/4" 042 20 08 R TT SS
042.36.00052	V3+FR+L 1/4" 042 20 12 R TT SS
042.36.00115	V3+FR+L 1/4" 042 5 08 R TT SS
042.36.00116	V3+FR+L 1/4" 042 5 12 R TT SS
042.36.00130	V3+FR+L 1/4" 042 20 08 R TC SS
042.36.00131	V3+FR+L 1/4" 042 20 12 R TC SS
042.36.00132	V3+FR+L 1/4" 042 5 08 R TC SS
042.36.00133	V3+FR+L 1/4" 042 5 12 R TC SS
042.36.00500	V3+FR+L 1/4" 042 20 08 R TT SS VL
042.36.00504	V3+FR+L 1/4" 042 20 12 R TT SS VL
042.36.00072	V3+FR+L 1/4" 042 20 08 R PE SS
042.36.00126	V3+FR+L 1/4" 042 20 12 R PE SS
042.36.00128	V3+FR+L 1/4" 042 5 08 R PE SS
042.36.00129	V3+FR+L 1/4" 042 5 12 R PE SS
042.36.00501	V3+FR+L 1/4" 042 20 08 R PE SS VL
042.36.00505	V3+FR+L 1/4" 042 20 12 R PE SS VL

Versione Scarico Automatico a galleggiante
Float type automatic drain version

042.36.00151	V3+FR+L 1/4" 042 20 08 R TT SA
042.36.00153	V3+FR+L 1/4" 042 20 12 R TT SA
042.36.00157	V3+FR+L 1/4" 042 20 08 R PE SA
042.36.00159	V3+FR+L 1/4" 042 20 12 R PE SA

Versione Scarico Automatico "Differenziale"
"Differential" automatic drain version

042.36.00191	V3+FR+L 1/4" 042 20 08 R TT SAD
042.36.00192	V3+FR+L 1/4" 042 20 12 R TT SAD
042.36.00193	V3+FR+L 1/4" 042 20 08 R PE SAD
042.36.00194	V3+FR+L 1/4" 042 20 12 R PE SAD

Gruppo F+L
F+L Unit

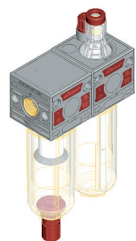

CODICE-CODE	REF.
→ 042.07.*****	F+L 1/4" 042 20 TT SS
042.07.00112	F+L 1/4" 042 5 TT SS
042.07.00132	F+L 1/4" 042 20 TC SS
042.07.00133	F+L 1/4" 042 5 TC SS
042.07.00500	F+L 1/4" 042 20 TT SS VL
→ 042.07.00072	F+L 1/4" 042 20 PE SS
042.07.00115	F+L 1/4" 042 5 PE SS
042.07.00501	F+L 1/4" 042 20 PE SS VL

Versione Scarico Automatico a galleggiante
Float type automatic drain version

042.07.00151	F+L 1/4" 042 20 TT SA
042.07.00152	F+L 1/4" 042 5 TT SA
042.07.00510	F+L 1/4" 042 20 TT SA VL
042.07.00153	F+L 1/4" 042 20 PE SA
042.07.00154	F+L 1/4" 042 5 PE SA
042.07.00513	F+L 1/4" 042 20 PE SA VL

Versione Scarico Automatico "Differenziale"
"Differential" automatic drain version

042.07.00128	F+L 1/4" 042 20 TT SAD
042.07.00129	F+L 1/4" 042 5 TT SAD
042.07.00130	F+L 1/4" 042 20 PE SAD
042.07.00131	F+L 1/4" 042 5 PE SAD

Gruppo F+MF
F+MF Unit

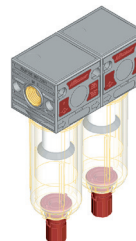

CODICE-CODE	REF.
→ 042.09.00001	F 1/4" 042 5 TT SS+MF 1/4" 0,01 TT SS
042.09.00003	F 1/4" 042 5 PE SS+MF 1/4" 0,01 PE SS
042.09.00005	F 1/4" 042 5 TC SS+MF 1/4" 0,01 TC SS

Versione Scarico Automatico a galleggiante
Float type automatic drain version

042.09.00002	F 1/4" 042 5 TT SS+MF 1/4" 0,01 TT SA
042.09.00004	F 1/4" 042 5 PE SS+MF 1/4" 0,01 PE SA

Versione Scarico Automatico "Differenziale"
"Differential" automatic drain version

042.09.00005	F 1/4" 042 5 TT SS+MF 1/4" 0,01 TT SAD
042.09.00006	F 1/4" 042 5 PE SS+MF 1/4" 0,01 PE SAD

Modular line

AIRCOMP

042 1/4"

Codici di ordinazione
Order Code

Kit staffa di fissaggio a "T"
"T" bracket kit

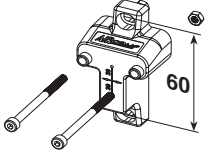

CODICE-CODE
C42.05.00001

Preso d'aria intermedia per unità
Air takeoff for units

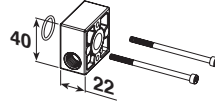

CODICE-CODE	CONNECTION	PRODUCT
C40.05.00102	1/8"	F+R+L - FR+L V3+FR+L - F+L - F+MF
C40.05.00108	1/4"	F+R+L - FR+L V3+FR+L - F+L - F+MF
C40.05.00103	2 WAYS (1/4"-1/8")	F+R+L - FR+L V3+FR+L - F+L - F+MF

Kit per assemblaggio unità
Kit assembling units

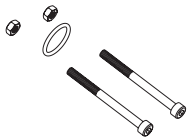

CODICE-CODE	PRODUCT
C40.05.00001	F+R+L - V3+FR+L
C40.06.00001	FR+L
C40.07.00001	F+L - F+MF

Preso d'aria intermedia per batterie
Battery air take-off

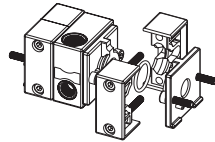

CODICE-CODE	CONNECTIONS
C42.05.00003	n°1 G1/4"- n°2 G1/8"

Kit per assemblaggio batterie
Battery assembling kit

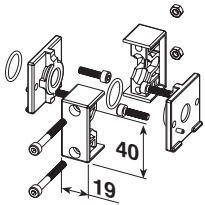

CODICE-CODE
C42.06.00001

Preso d'aria ingresso
Inlet air take-off

NEW

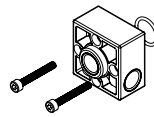

CODICE-CODE	CONNECTIONS
C42.06.00002	G1/4"- G1/4"

Grano
Plug



CODICE-CODE	CONNECTION
B38.00.00018	G1/8"
A42.01.00010	G1/4" (air takeoff)

Preso d'aria uscita
Outlet air take-off

NEW

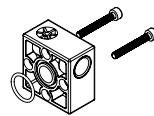

CODICE-CODE	CONNECTIONS
C42.06.00003	G1/4"- G1/4"